



## M3 Mechanical Seal for Clean Water Pumps, Circulating Pumps and Vacuum Pumps M3型机械密封

**Structural Features:** single end, unbalanced, conical spring, dependent direction of rotation, spring transmission. This seal component has a simple structure, high compatibility and stable performance with great spring compensation.  
**结构特点:** 单端面, 锥型弹簧, 非平衡型, 旋向固定, 弹簧传动。结构简单, 适用范围广, 性能稳定, 弹簧补偿范围大。

**Standards:** ISO3069, GB6556, DIN24960  
**符合标准:** ISO3069, GB6556, DIN24960

**Scopes of Application:** widely used in chemical centrifugal pumps, clean water pumps, sewage pumps, temperature control pumps, submerged pumps, and heat-transfer oil pumps. Mainly used in oil refining, chemical engineering, chemical product transportation, water treatment and chemical fiber industry. This product can be an alternative to similar products from EG&G SEAL OL, Flexibox and Roten.  
**应用领域:** 广泛应用于石油、化工、化工运输、水处理, 化纤等领域。可同化工泵、清水泵、污水泵、双吸泵、潜水泵、管道泵等旋转设备配套。

**Inner Diameter:** 8 mm to 100 mm  
**规格范围:** 8 mm - 100 mm

### Materials

Rotary Ring Face: Carbon/SiC/TC  
Stationary Ring Face: Carbon/SiC/TC  
Elastomers: NBR/Viton/EPDM/PTFE/FFKM  
Springs: SS304/SS316  
Metal Parts: 410S/SS304/SS316/SS316L

### 材料

旋转环端面: 石墨/碳化硅/碳化钨  
静止环端面: 石墨/碳化硅/碳化钨  
辅助密封: 丁腈橡胶/氟橡胶/三元乙丙橡胶/聚四氟乙烯/全氟醚橡胶  
弹簧: SS304/SS316  
金属部件: 410S/SS304/SS316/SS316L

### Operation Parameters

Pressure:  $\leq 1.0$  MPa  
Temperature:  $-20 \sim 180$  °C  
Linear Speed:  $\leq 10$  m/s

### 运行参数

压力:  $\leq 1.0$  MPa  
温度:  $-20 \sim 180$  °C  
线速度:  $\leq 10$  m/s

**Mediums:** oil, water, amorphism acid, alkali, salt, and organic solvents.

**适用介质:** 水、油、非结晶性酸、碱、盐有机溶剂等。

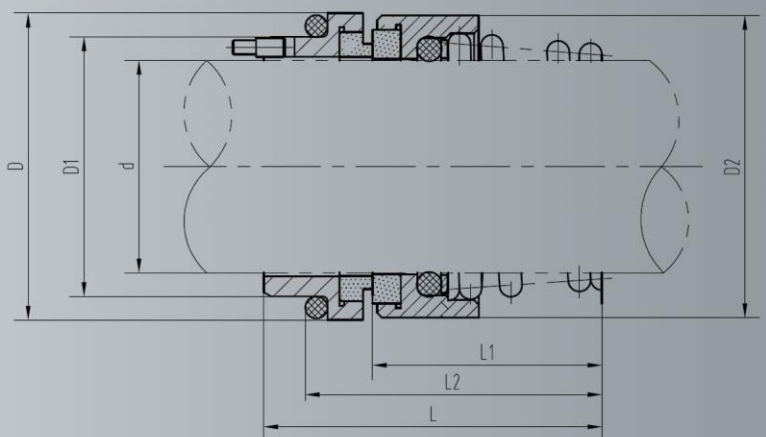

M3 Mechanical Seal Dimension Chart - M3型机械密封尺寸对照表

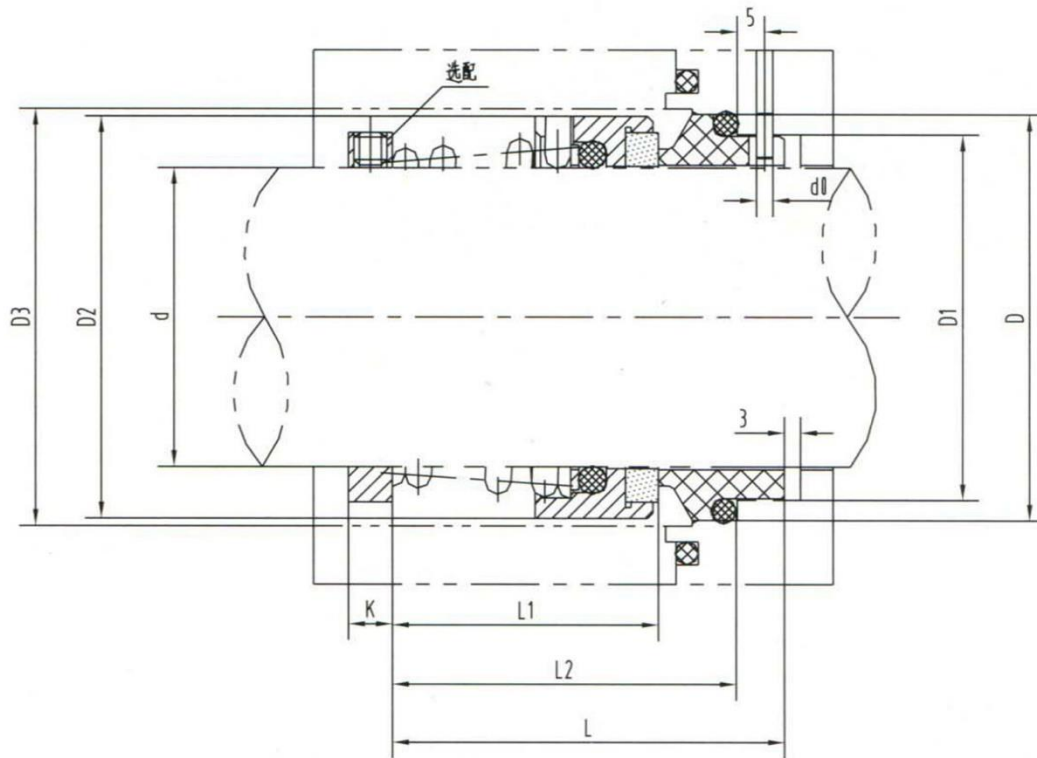

Dimensions	d	D	D1	D2	D3	L	L1	L2	d0	K
Shaft Sizes	h6	H8	H11							
18	18	33	27	31	37	37.5	18.0	29.5	3	9
20	20	35	29	34	39	38.5	19.0	30.5	3	9
22	22	37	31	36	41	40.0	20.5	32.0	3	9
24	24	39	33	38	43	41.5	22.0	33.5	3	9
25	25	40	34	39	45	43.0	23.5	35.0	3	9
28	28	43	37	42	47	44.0	24.5	36.0	3	9
30	30	45	39	44	49	44.0	24.5	36.0	3	9
33	33	48	42	47	51	47.5	28.0	39.5	3	9
35	35	50	44	49	54	47.5	28.0	39.5	3	9
38	38	56	49	54	59	53.0	31.0	45.0	4	9
40	40	58	51	56	61	56.0	34.0	48.0	4	9
43	43	61	54	59	65	57.0	35.0	49.0	4	9
45	45	63	56	61	66	58.5	36.5	50.5	4	9
48	48	66	59	64	69	64.0	42.0	56.0	4	9
50	50	70	62	66	71	66.0	43.0	58.0	4	9
53	53	73	65	69	75	70.0	47.0	62.0	4	9
55	55	75	67	71	76	70.0	47.0	62.0	4	9
58	58	78	70	78	83	73.0	50.0	65.0	4	9
60	60	80	72	79	85	74.0	51.0	66.0	4	9
65	65	85	77	85	90	75.0	52.0	67.0	4	9
70	70	92	83	90	95	80.0	54.0	72.0	4	10
75	75	97	88	98	105	80.0	54.0	72.0	4	10
80	80	105	95	103	109	84.0	58.0	76.0	4	10
85	85	110	100	108	114	87.5	61.5	81.0	4	10
90	90	115	105	113	119	87.5	61.5	81.0	4	10